

Edmonton **Woman's** Show

April 21st and 22nd, 2018
Edmonton EXPO Centre

Experience the power of women!

For **over 30 years**, the Edmonton Woman's Show has acted as a 'choose your own adventure' for women, providing a fun-filled weekend full of entertainment, businesses, and activities to indulge in. Our vision is to enhance the lives of women through inspiration, consumer choices, and celebration of their unique identities. By sharing this vision with us as an exhibitor, you gain the opportunity to make valuable, lasting relationships with this powerful demographic.

- ~5,300 people visited the 2017 Spring Edmonton Woman's Show
- Over half were return visitors to the Show
- Three out of every four said they'd come again
- Over one third of attendees heard about the Show through Word of Mouth

*The Edmonton Woman's Show is a celebration of the extraordinary power women hold - both as individuals and as a collective. Together, women drive 70-80% of all consumer purchasing!**

*according to a 2015 Forbes report

Women are extremely intelligent consumers, and we all know it is not adequate to simply splash something in pink in order to attract them. The Edmonton Woman's Show gives you the perfect opportunity to not just tell, but *show* them that you are willing to work hard to earn their loyalty and their spending dollars. When they see and understand that your company cares about them as individuals and aligns with their values, you connect with them on an emotional level - forging a truly unshakeable bond.

The Edmonton Woman's Show is an amazing way to cultivate new relationships and foster current ones - and we want you to be a part of it!

Apply early to ensure prime positioning and to take advantage of early registration prices. Signing up early will ensure the best possible pre-promotion for your brand.

Get involved as an exhibitor or sponsor and discover the power of women - and the true potential of your business!

- Family Productions Inc. was formed in 1993
- Since 2005, we've done nearly **10 million dollars'** worth of media advertising across all of our shows!
- We are proud members of the Canadian Association of Exposition Management (CAEM)

Want to know more?

Family Productions Inc.



Phone: (780) 490-0215

Fax: (780) 450-3757

Business GST No. 888484615RP0001

Email: info@edmontonshows.com

www.EdmontonShows.com

2nd Floor, 4634-90A Avenue

Edmonton, Alberta T6B 2P9

Exhibit Space Application

April 21st and 22nd

Saturday 10 am – 5 pm
Sunday 11 am – 5 pm

Edmonton EXPO Centre

www.EdmontonShows.com

Phone: (780) 490-0215

Fax: (780) 450-3757

GST No.888484615RP0001

Edmonton **Woman's** Show 

Spring – 2018

Office Use Only

Date Received _____

Invoice # _____

Conditions _____

Booth Size _____

Booth # _____

Invoice Manual Tickets

Insurance Attached

Procedure

1. Fill out the application as completely as possible.
2. Submit along with payment (*no application will be processed without payment*).
Fax, on-line, or in person only. No phone registrations accepted.
3. Confirmed registrations will be e-mailed an **Invoice** (*immediately*).
4. Submit your *proof of Liability Insurance* to our office. This is *required* prior to participation in the show.
5. Instructions to the **Exhibitor Manual** will be sent shortly thereafter, starting 8 weeks out from the Show.
Note: If nothing is received, please check your junk folder or call in to have it resent.
6. Review Exhibitor Manual (*follow the instructions as they are applicable to your needs*).
7. Send in Exhibitor Staff List Form by required date.

Applicant is responsible for following up should an invoice or Exhibitor Manual not be received, as well as for reviewing both documents.

Company Name: _____

Is this the name to appear in the public Exhibitor Listings? Yes No, use _____

If your company is known by any other names include them here: _____

Contact: _____ **Position Title:** _____

Phone: _____ **Cell:** _____

Address: _____
City Province Postal Code

Complimentary tickets are to be sent to a different contact/address, as indicated on the line below: (*include FULL mailing information*)

E-Mail Address: (*write clearly*): _____

Note: Invoices and instructions to the Exhibitor Manual will be sent to the e-mail address above.

Also send a copy of the instructions to the Exhibitor Manual to a 2nd person. Email: _____

List and/or describe the **type of product(s) and/or services(s)** to be displayed, along with any materials or samples to be distributed. Undisclosed products or services, along with unauthorized third party promotion, are not permitted and may be removed at the discretion of show management.

Reminder: Balloon restrictions DO apply. Contact office for additional information.

****** ATTENTION EXHIBITORS ******

Encroachment: Exhibitors will be charged at a premium rate for any spillage into the aisles or into another exhibit space during the hours of the event. Please ensure you have booked yourself enough space.

All Booths include applicable 8' back draping and 4' side draping. All other Booth Accessories must be ordered.

- 10'x6' & 10'x10' spaces include six (6) exhibitor wristbands and twenty (10) complimentary passes.
- 10'x20' or greater include up to twelve (12) exhibitor wristbands and forty (20) complimentary passes.

Please note that exhibitor wristbands are for booth employees only.

Additional wristbands can be purchased in advance for a nominal fee. (See Show Extras)

Please use the **Power Needs, Show Extras, and Booth Accessories** areas below to order any of your booth requirements.

Parking Passes are available for purchase ONLINE through Northlands closer to show date.

***** There are savings by preordering your booth accessories in advance through Family Productions Inc. *****

Price Break that will apply is determined by the date on which our office RECEIVES the application

(NOT necessarily the day on which it is dated). No Exceptions.

Exhibit Space Size		Price Break Deadlines (Select Appropriate Price Column)					
Select:		Price Expires May 26 '17	Price Expires July 28 '17	Price Expires September 29 '17	Price Expires November 24 '17	Price Expires January 26 '18	Price Expires April 20 '18
<input type="checkbox"/>	10'x6' <i>Home Based Only</i>	\$876	\$976	\$1,000	\$1,050	\$1,126	\$1,152
<input type="checkbox"/>	10'x6' Corner <i>Home Based Only</i>	\$952	\$1,052	\$1,076	\$1,126	\$1,202	\$1,228
<input type="checkbox"/>	10'x10'	\$1,350	\$1,450	\$1,476	\$1,526	\$1,550	\$1,576
<input type="checkbox"/>	10'x10' Corner	\$1,400	\$1,500	\$1,526	\$1,576	\$1,600	\$1,626
<input type="checkbox"/>	10'x20'	\$2,540	\$2,740	\$2,792	\$2,852	\$2,940	\$2,992
<input type="checkbox"/>	10'x30'	\$3,600	\$3,900	\$3,978	\$4,128	\$4,200	\$4,278
<input type="checkbox"/>	20'x20'	\$4,200	\$4,450	\$4,528	\$4,700	\$4,750	\$4,750

* Exhibit prices subject to change at the discretion of Family Productions Inc.

* Exhibit Prices are valid for this application only.

* If booking both shows use the price of the earliest price break (left most column) * **All Exhibit Spaces (Booth) Prices Subject To 5% GST ***

SEWS18 Booth Cost Total

(Use proper amount from above table)

\$

I would also like to book into the 2018 Fall Edmonton Woman's Show (October 13 & 14, 2018), and get both booths at the price of the earliest price break (left most column) *****FEWS18 Booth Cost Total*****

\$

*Power Needs	Price	Calculation	Total
<input type="checkbox"/> 1500 watts/120 volts (E1500)	\$134	___ x \$134 =	\$
<input type="checkbox"/> 1500 watts/120 volts (24-hour) (E150024)	\$174	___ x \$174 =	\$
<input type="checkbox"/> Flood Lights 2 - 24 Watt LED fixtures on 8' Telescopic Stand (Power included for lights ONLY. No additional plug-ins) (L2150)	\$126	___ x \$ 126 =	\$
<input type="checkbox"/> Source 4 Par Fixture (Ceiling Light) (Power included for lights ONLY. No additional plug-ins) (L575S4)	\$221	___ x \$221 =	\$
<input type="checkbox"/> Man-lift Services (ex. Hanging banners/signs)	\$215 per hour	___ x \$215 =	\$
Power Needs Total (add all totals in column)			\$
Power Prices are valid for this application only. **Prices subject to change without notice****			**** All Booth Power Needs Prices Subject To 5% GST ****
<input type="checkbox"/> I have also booked into the 2018 Fall Edmonton Woman's Show and would like to order the same power add-ons as indicated above (** write total again **)			*** All Booth Power Needs Prices Subject To 5% GST ***
			\$

*Show Extras	Price	Calculation	Total
Exhibitor Weekend Parking Passes (unlimited access) are available for purchase ONLINE through Northlands closer to show date.			
<input type="checkbox"/> 4x4 Additional Storage Request**	\$75 for the weekend	___ x \$75 =	\$
<input type="checkbox"/> Mascot Changing Area *All mascots must be approved by show management in advance	\$125 for the weekend	___ x \$125 =	\$
<input type="checkbox"/> Extra Exhibitor Wristbands (Over the included booth amount)	\$8 per wristband	___ x \$8 =	\$
*Show Extras Prices are valid for this application only. ** Storage Space is limited and may not be available. *** Family Productions Inc. assumes no responsibility for items stored.			Show Extras Total (add all totals in column) ***All Show Extras Prices Subject To 5% GST***
<input type="checkbox"/> I have also booked into the 2018 Fall Edmonton Woman's Show and would like to order the same Show Extras as indicated above (** write total again **)			\$

*Booth Accessories	Edmonton Shows Advance Prices	Preorder Calculation	Total
<input type="checkbox"/> Carpet	\$84 per 60 square feet (10 x 6 space)	___ x \$84 =	\$
<input type="checkbox"/> Carpet Underlay	\$57 per 60 square feet (10 x 6 space)	___ x \$57 =	\$
<input type="checkbox"/> Carpet	\$140 per 100 square feet (10x10 space)	___ x \$140 =	\$
<input type="checkbox"/> Carpet Underlay	\$95 per 100 square feet (10x10 space)	___ x \$95 =	\$
<input type="checkbox"/> Skirted Tables	___ 4' ___ 6' ___ 8' \$75 per Table	___ x \$75 =	\$
<input type="checkbox"/> Raised Table Skirted	Add \$30 per table (any 4' 6' 8' sizes)	___ x \$30 =	\$
<input type="checkbox"/> Folding Chairs	\$16 per chair	___ x \$16 =	\$
<input type="checkbox"/> High Stools w/back	\$80 per stool	___ x \$80 =	\$
Booth Accessories Packages	Choose Table Size and number of Chairs	Package Calculation	*****
10 x 6 Deluxe: (per space) Includes: Underlay, Carpet, 1 Table skirted, 2 Chairs	___ 4' ___ 6' ___ 8' ___ Chairs	___ x \$226 =	\$
10 x 10 Deluxe: (per space) Includes: Underlay, Carpet, 1 Table skirted, 2 Chairs	___ 4' ___ 6' ___ 8' ___ Chairs	___ x \$320 =	\$
10 x 20 Deluxe: (per space) Includes: Underlay, Carpet, 2 Table skirted, 4 Chairs	___ 4' ___ 6' ___ 8' ___ Chairs	___ x \$620 =	\$
20 x 20 Deluxe: (per space) Includes: Underlay, Carpet, 3 Table skirted, 6 Chairs	___ 4' ___ 6' ___ 8' ___ Chairs	___ x \$1,190 =	\$
Booth Accessories Prices are valid for this application only.			.Booth Accessories Total (add all totals in column) ** All Booth Accessories Prices Subject To 5% GST ****
<input type="checkbox"/> I have also booked into the 2018 Fall Edmonton Woman's Show and would like to order the same Booth Accessories as indicated above (** write total again **)			\$

*Ticket Purchase Special	Price (General admission tickets only)	Calculation	Total
<input type="checkbox"/> Under 25 Tickets	\$9.52 per Ticket	___ X \$9.52 =	\$
<input type="checkbox"/> 25 – 50 Tickets	\$8.60 per Ticket	___ X \$8.60 =	\$
<input type="checkbox"/> 60 Plus Tickets	\$7.60 per Ticket	___ X \$7.60 =	\$
Tickets can be purchased for personal guests, clients, or promotional purposes * Ticket Purchase Specials are valid for this application only **Pre-ordered discounted General Admission tickets have no cash value and are non-refundable.			Ticket Purchase Total (add totals in column) ***All Ticket Prices Subject To 5% GST***
<input type="checkbox"/> I have also booked into the 2018 Fall Edmonton Woman's Show and would like to order the same. (write total again)			\$

Additional Promotions		Exhibitor	Non-Exhibitor
Note: All Items are subject to <u>availability</u> and <u>approval</u> by Family Productions Inc.			
Show Guide			
<input type="checkbox"/> Full Ad 9.5" w x 8.5" h	Provided to the visitors at the front doors. Includes map and listings of all exhibitors. Luna Gloss, full-colour. Artwork must be photo ready or an additional charge will apply. Artwork due: March 3rd, 2018	\$700	\$1,080
<input type="checkbox"/> Half Ad 4.5" w x 8.5" h		\$350	\$775
<input type="checkbox"/> Quarter Ad 4.5" w x 4.25" h		\$175	\$575
At the Door			
<input type="checkbox"/> "Early Bird" Gift Bag Inclusion	Item(s) included in a gift bag provided to the earliest visitors each day. Product samples, full-service certificates, 2-for-1 or 50% off offers ONLY. 400 suggested. *Promotion only available if early-bird gift bag sponsor is confirmed	FREE	\$50
<input type="checkbox"/> Gift Bag Sponsorship	(Your logo on one side, Show logo on opposite side.) \$1.99/each in quantities of 500 or 1000. For 5,000 or more: \$1.75 each (Qty. _____) <i>*price per bag is subject to change. Please contact our office for most up-to-date rates.</i>	\$995 or \$1,990 or \$	\$995 or \$1,990 or \$
<input type="checkbox"/> Distribution	Product or product samples made available at the front doors. Quantity depends on product. Please call us to determine amount suitably required.	\$515	\$1,648
<input type="checkbox"/> Exit Survey Sponsorship	Product available to visitors upon completion of the Exit Survey. 400-600 suggested. (No coupons or flyers; product must have minimum \$5 retail value)	FREE	\$206
Presentation Area			
<input type="checkbox"/> Presentation	25-minute presentation on the Main Stage. Focus is to be informational (as opposed to a sales pitch). Includes mention in Show Guide schedule*.	\$618	\$824
<input type="checkbox"/> Cooking Stage Presentation <i>Woman's Shows Only</i>	25-minute presentation on the Cooking Stage - Includes appliances and prep area behind stage with sink for cleanup. Not included: Ingredients, Chef, Cooking utensils - pots, pans, knives etc. or sampling utensils - plates, forks, etc. Must supply your own for presentation.	\$350	\$350
Other			
<input type="checkbox"/> Screen Ads	Have your ad placed in a rotation of ads on a screen, and have it on-screen at least sixty-six (66) times throughout the weekend. Screen ads will rotate continuously throughout the show whenever the screen is not in use.	\$790	\$1285
<input type="checkbox"/> Overhead Sound	Get your messaging in the ears of attendees - get 6 overhead announcements over the weekend from our media emcee, strengthening your brands' presence at the Show.	\$525	\$1050
<input type="checkbox"/> Mannequin display	*Mannequins, clothing, all accessories, and freestanding signage for each mannequin indicating where the outfit came from must be supplied by your store. Mannequins must be dropped off at the Edmonton EXPO Centre and dressed by 5:00 pm on Friday Move-in, and must be picked up by 6:00 pm on Sunday Move-out. **Please note that Family Productions Inc. is not responsible for any lost, stolen, or damaged	\$50.00 each	\$50.00 each
<input type="checkbox"/> 25-Minute Consultation with Show Producer	25-minute consultation with our Show Producer (Louise Reinich) – select this option to schedule a meeting at our office where you can discuss your booth, business strategy for the show, proper boothmanship, and all sorts of tips and tricks for trade show success.	FREE	N/A
Additional Promotions Total (add all totals in column) **** All Additional Promotions Prices Subject To 5% GST		\$	
<input type="checkbox"/> I have also booked into the 2018 Fall Edmonton Woman's Show and would like to order the same Additional Promotions as indicated above (write total again) *All Additional Promotions Prices Subject To 5% GST *		\$	

Required

- **Product Samples** – list the number to be provided and describe them below
 - **Full Service Certificates**– list the number to be provided and describe them below and/or a submit sample
 - **Presentations** – describe *in detail* below, including the topic(s) to be covered, length, name and any relevant background of the speaker(s), special needs or requests (additional charges may apply), and any other information pertinent to your presentation.
- Note: If any stage cleanup is necessary, it must be completed within the 25 minute time slot allotted. Please adjust your presentation time accordingly.**

Please Read the Terms of Contract (below) and Conditions of Contract (attached) Before Signing.

- **All Exhibitors must have general liability insurance for the dates and location of the show.**
Insurance has to be a Minimum two million (\$2,000,000.00) general liability coverage.
Exhibitors must submit a Certificate of Insurance to our office at least two (2) weeks prior to show.
The Certificate of Insurance must include the Edmonton EXPO Centre at Northlands and Family Productions Inc. as **additional insured** for the weekend of the show.
*****Please Note:** Your Insurance Company can transfer your existing Business Liability insurance to the show for the weekend and add the required additional insured (as above). If you do not have existing business coverage, you will be required to purchase insurance designed specifically for exhibitors. Please contact our office for Provider recommendations.
- All Applications are Subject to a 3 % processing Fee.
- 50% non-refundable deposit on submission of contract.
- 50% non- refundable balance on contract for Each Show By SEWS18 February 2, 2018 and FEWS18 August 14, 2018
- **100% Non-refundable payment for SEWS18 and 50% Non-refundable deposit required for FEWS18 on applications** received on or after February 2, 2018
- 2% per month will be added to overdue accounts.

	Shows	SEWS18	FEWS18
(Exhibit Space) Booth Total	\$	\$	\$
Power Needs Total	\$	\$	\$
Show Extras Total	\$	\$	\$
Booth Accessories Total	\$	\$	\$
Ticket Purchase Total	\$	\$	\$
Additional Promotions Total	\$	\$	\$
Booth Subtotal Amount	\$	\$	\$
Plus GST	\$	\$	\$
Total Booth Amount	\$	\$	\$
3 % Application Process Fee (on the above Total Booth Amount)	\$	\$	\$
Total Booth Contract Amount	\$	\$	\$
Total Contract SEWS18+FEWS18	\$		

Cancellation Policy When Booking Both Shows: Exhibitors who book both shows and cancel out of one show, making it so that they do not meet the requirements to qualify for the both Show booth discounts, will be required to pay the difference between the actual cost of the booth (the regular booth cost as per the date we received the application) and the discounted cost (the cost of the booth at the earliest price break) on the show already participated in, as well as the appropriate balance as per the cancellation policy in the Conditions of Contract (attached).

I.E., if an exhibitor does not participate in both shows booked, making the cancelation bring them below the both show requirement for booth discounts, they are responsible for paying the full Booth price for the show they did participate in (based on regular booth prices as per the date of contract) and the appropriate balance owing on the shows cancelled as per the Conditions of Contract - as if they had only booked and paid for one Show at a time.

Are you authorized to sign for the company?

Yes No

We agree to pay Family Productions Inc. \$ _____ and to abide by the **Terms and Conditions of Contract** adopted by Family Productions Inc. and the Edmonton Woman's Show.

Signature: _____ **Date:** _____

****Please note: If you pay by cash or pay the Total Booth Amount in full upfront, the 3% Application Process Fee will be waived. N/A after 02/3/2018**

Cheque / Money order enclosed **Full invoice amount required if paying by cheque** Do not send money in the mail.

Credit Card Payment Option (select ALL appropriate options) ** Registrations will not be processed without payment ****

I authorize \$ _____ from my credit card upon processing of this contract to satisfy the 50% deposit of Both Shows

I authorize \$ _____ from my credit card on February 2, 2018 to satisfy the balance of the SEWS18 Contract

I authorize \$ _____ from my credit card on August 14, 2018 to satisfy the balance of the FEWS18 Contract

I authorize \$ _____ from my credit card to satisfy the 100% total due for the Total Contract upon its processing

Card Number: _____ Expiry Date: _____

Name on Card: _____ Signature: _____

Mail to: 2nd Floor 4634 – 90A Avenue Edmonton Alberta T6B 2P9 or Fax to: (780) 450 – 3757

Family Productions Inc. Business/GST No. 888484615RP0001

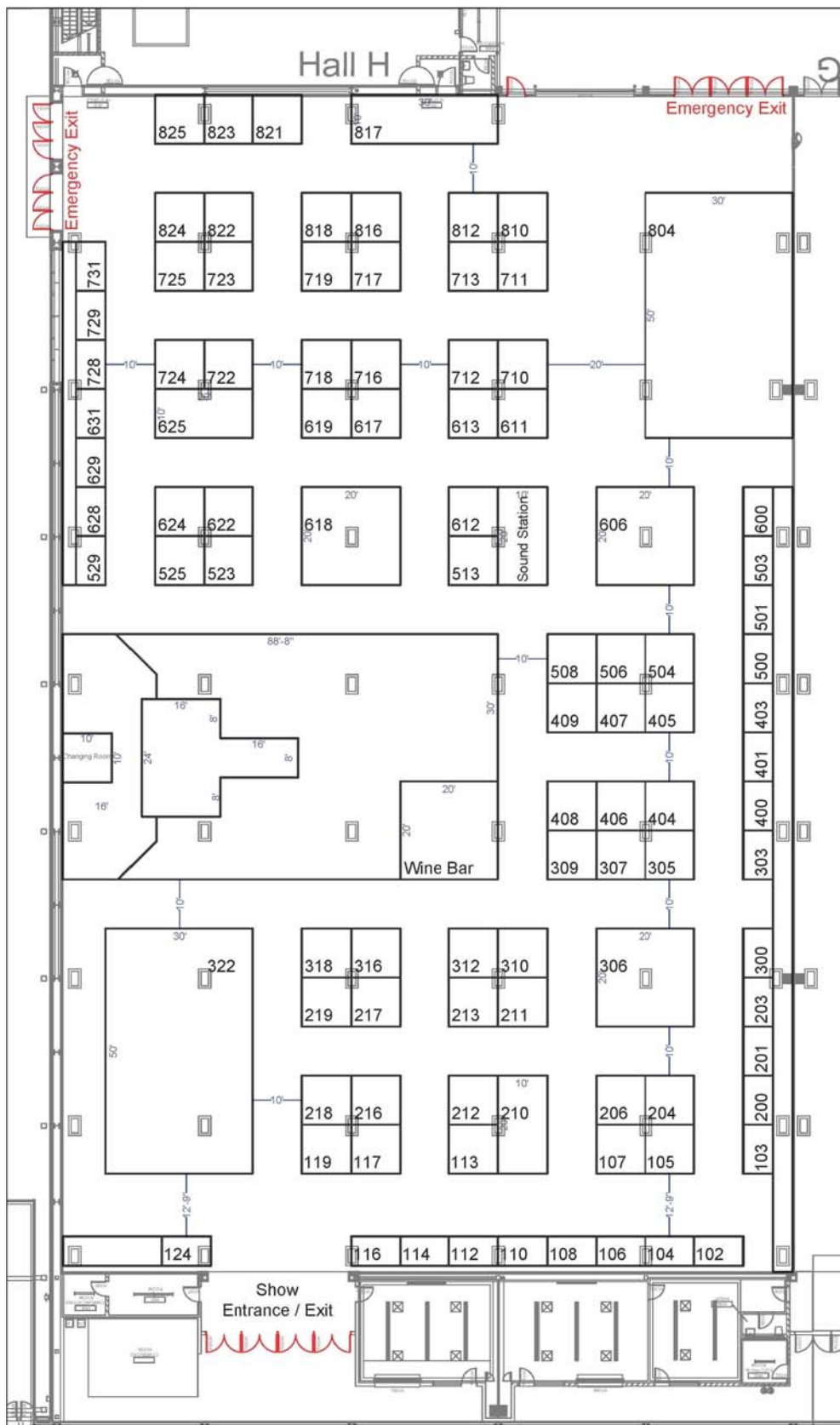

Scale: 1:400



Event Specialists
 780.992.0404
 Fort Saskatchewan and Airdrie, AB.
 www.superiorshow.com
Serving the community through Superior events

Spring Edmonton Woman's Show

April 21 & 22, 2018

Floor plan is intended for the sole use of our Clients and is subject to change.

Edmonton Northlands Expo Centre; Hall H

Revised By E.O. on Apr. 4/17

CONDITIONS OF CONTRACT - EXHIBITOR

For the purposes of these conditions Family Productions Inc. shall herein be referred to as Management, the event shall be referred to as the Show, and the exhibitor shall be referred to as Exhibitor.

1. **RULES & REGULATIONS:** The Exhibitor agrees to abide by all regulations and rules adopted by Management in the best interest of the Show, and agree that Management shall have the final decision in adopting any rule or regulation deemed necessary prior to, during and after the Show. All Exhibitors will be required to observe such further rules and regulations as Management may consider it necessary to impose for the success, safety, and well being of the Show, Exhibitors, and others attending the Show.
2. **LOSS OR DAMAGE:** Exhibitor will be liable for and will indemnify and hold harmless Management from any loss of damages whatsoever suffered by the Show as a result of any loss or damages whatsoever occurring to or suffered by any person or company, including, without limiting the generality of the foregoing, the Exhibitor, other Exhibitors, Show Sponsors, Management, the Show, the owners of the building, their respective agents, servants and employees, and attendees of the Show (public), either on the said space or elsewhere if said loss or damages arose from or were in any way connected with Exhibitor's occupancy of said space.
 - a. Management assumes no responsibility whatsoever for loss or damage of goods before, during the period of the Show, or after its close. Management is hereby expressly released and discharged from any and all liability from any loss or damages.
3. **FORCE MAJEURE:** Management shall not be liable in damages or otherwise for failure to carry out the terms of this agreement in whole or in part where caused directly or indirectly by or in consequence of fire, storm, flood, war, rebellion, insurrection, riot, civil commotion, strike or by any cause whatsoever beyond the control of Management whether similar to or dissimilar from the causes enumerated herein.
4. **CANCELLATION:** This contract may be cancelled by either party provided written notice is received by the other at least eight (8) weeks prior to the first day of the Show, in which case the Exhibitor will be responsible for 50% of the total contracted amount. If the Exhibitor cancels after this date the Exhibitor will be liable for 100% of the total contracted space costs. By cancelling this contract the Exhibitor forfeits all rights or claims to the allocated space and Management is free to rent it to others and collect the cancellation charge as liquidation damages.
 - a. Management reserves the right to cancel this contract and to withhold possession of exhibit space if the Exhibitor fails to perform any material condition of this contract or refuses to abide by the Conditions of Contract, in which case the Exhibitor shall forfeit as liquidated damages all space rental payments made by him and any further occupancy of such space.
5. **DATE/VENUE CHANGE:** If the Management shall consider it inadvisable to hold the said Show at the time and/or place herein provided, Management shall have the right to change the date and/or place within the same City, giving the Exhibitor written notice thereof by e-mail addressed to the e-mail address given herein.
6. **BOOTH ASSIGNMENT:** Management reserves the right to alter or change the space assigned to the Exhibitor.
7. **EXCLUSIVITY:** Management does not provide Exhibitors with exclusivity to any one particular product or service unless specifically negotiated in writing through sponsorship.
8. **INSURANCE:** The Exhibitor is responsible for the acquisition and cost of insurance related to their participation in the Show in advance of the Show. Proof of Insurance must be submitted to Family Productions Inc. one week prior to scheduled Show move-in.
9. **DISPLAY:** The Exhibitor agrees that no display may be dismantled or goods removed during the entire run of the Show but must remain intact until the closing hour of the last day of the Show. The Exhibitor also agrees to remove his exhibit, equipment and appurtenances from the Show building by the final move-out time limit, or in the event of failure to do so, the Exhibitor agrees to pay for such additional costs as may be incurred.

10. ENCROACHMENT: Exhibitor agrees to confine his presentation within the contracted space only, and within the maximum height of 8 feet to the back of the exhibit and 4 feet at the sides of the exhibit, unless agreed upon in writing with Management in advance of the Show.
11. SUBLETTING: Space contracted by the Exhibitor may not be sublet or re-sold without the prior written permission of Management.
12. THIRD PARTY PROMOTION: Exhibitor agrees to promote only the business(es) registered for and approved by Management. No third party promotion will be permitted without prior authorization by Management, in writing. This includes, but is not limited to, display and any sampling or distribution of materials (ex. business cards, brochures, etc.).
13. LIGHTING & ELECTRICAL: All electrical wiring and outlets shall be at the Exhibitor's expense, unless agreed upon in writing with Management in advance of the Show. All operating electrical equipment used in the exhibit must have C.S.A. or equivalent provincial power authority approval.
14. SALES/ADOPTIONS OF LIVE ANIMALS: The Exhibitor understands and agrees that no live animal will be sold or adopted off of the Show floor.
15. SECURITY: Management will provide necessary security for the building during the hours the Show is closed. Exhibitors must have an individual directly responsible for his own exhibit each day during the hours the Show is open.
16. REMOVAL: Management reserves the right at any time to alter or remove exhibits or any part thereof, including printed materials, product, signs, lights or sound, and to expel Exhibitors or their personnel if, in Management's opinion, their conduct or presentation is objectionable to other Show participants.
 - a. Management reserves the right to approve or disapprove of any and all products, materials or displays that are to be carried by the Exhibitor. The Exhibitor acknowledges that he is one of many Exhibitors and agrees to co-operate with the other Exhibitors and Sponsors and not to interfere with them or create any nuisance to them, the Management, or the people attending the Show. Any dispute among Exhibitors and/or Sponsors, including any conflict of products, or other materials, shall be settled by the Management, who shall have the final determination as to any such dispute.
17. UNIONS & LABOUR: The Exhibitor agrees to observe all union contracts and labour relations in force, agreements between Management, official contractors serving companies and the building in which the Show will take place and according to the labour laws of the jurisdiction in which the building is located.
18. PROMOTIONAL MEASURES: Where an Exhibitor offers or provides exhibition, raffles, donations, or other promotional measures that require guests to be present at a specified location and time or any other promotion plans, they must first be approved by Management.
19. PRIVACY: Exhibitor agrees to abide by all federal and provincial laws regarding the collection of personal information, including but not limited to, abstaining from the sale or sharing of personal information to a third party.
20. SHIPPING/DELIVERIES: All goods shipped to the Show must be clearly marked with the name of the Show, the name of the Exhibitor and the number of his space. Goods must not be shipped to the Show for shipping charges to be paid on arrival, as Management will not accept these charges. Management assumes no responsibility for loss or damage to goods before, during the period of the Show, nor after its closing.
21. PHOTOGRAPHS & VIDEO: Management reserves the rights to reproduce all photographs, images and likenesses taken during the Show for future promotional purposes.